

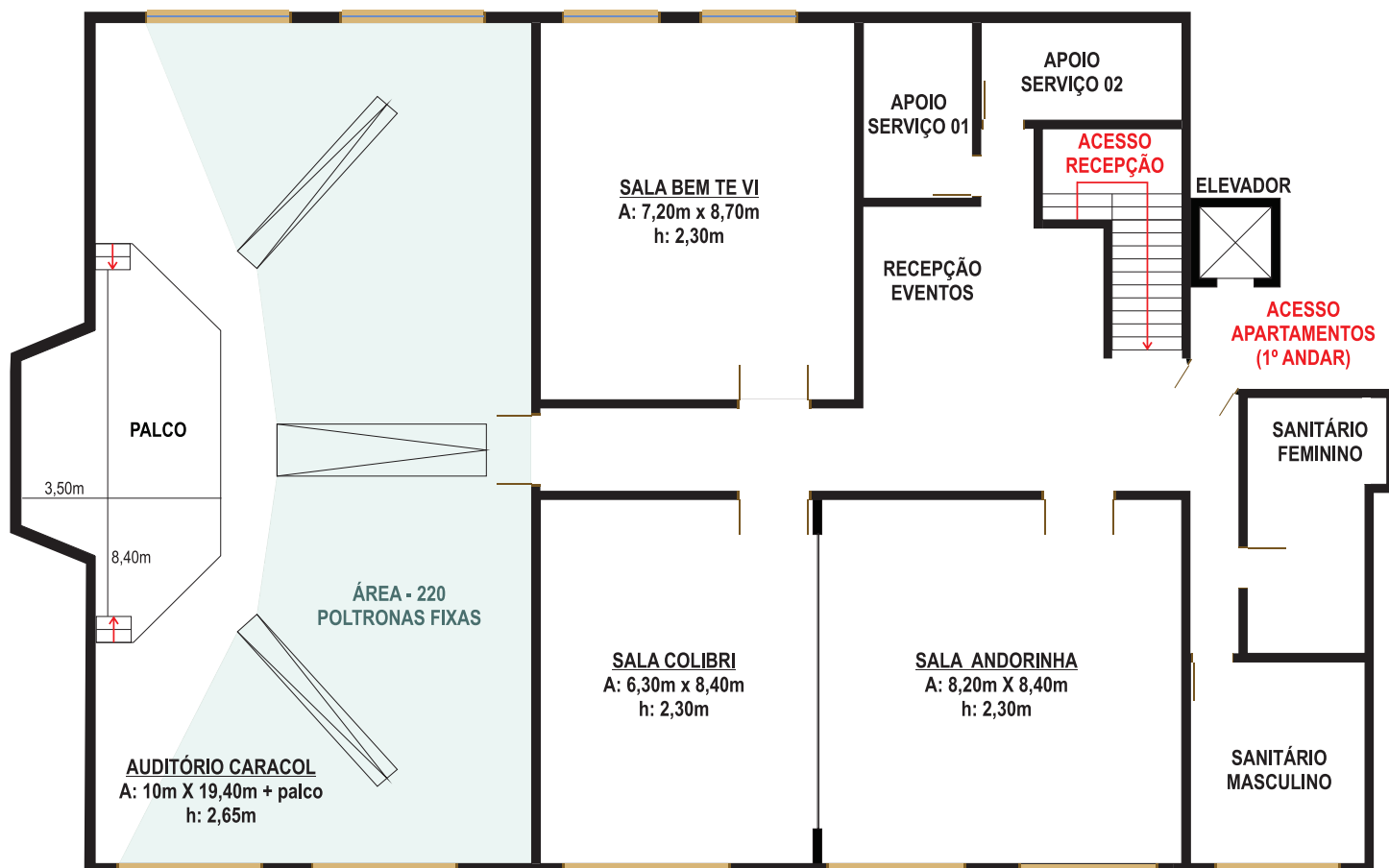







Hotel  
*Serra Nevada*



	MEDIDA		CAPACIDADE				
	ÁREA (m <sup>2</sup> )	PÉ DIREITO	AUDITÓRIO 	BANQUETE 	ESCOLAR 	ESP. PEIXE 	MESA "U" 
Auditório Caracol	206,40	2,65	220	-	-	-	-
Sala Bem-te-vi	63,00	2,30	70	40	40	40	30
Sala Andorinha	70,00	2,30	90	60	50	40	35
Sala Colibri	54,00	2,30	50	30	30	30	20
Sala Andorinha + Sala Colibri	124,00	2,30	140	90	80	80	45